

OMNIA

STAINLESS STEEL & MAX•STEEL





Omnia expands upon its collection of decorative door hardware with the Stainless Steel and Max•Steel latchsets and locksets. Both lines reflect the classic beauty and timeless appeal of stainless steel, while offering unparalleled levels of style and function.

Stainless Steel

Omnia's line of Stainless Steel lever latchsets and locksets is designed to enhance any setting where a modern, sophisticated look is desired. Every piece is strong and durable, made from premium grade material and coupled with interior components that prove worthy of Omnia's exceptional standards.

Max•Steel

Our innovative Max•Steel finish will change the way you think about stainless steel. The unique process employed in the manufacturing of our Max•Steel line provides superior resistance to tarnishing and pitting. The added benefit lies in the special malleability of Max•Steel which expands the range of design options that had been virtually impossible to produce in stainless steel. Elaborate, curvilinear and traditional designs that replicate the cool, crisp beauty of stainless steel are now within reach.

Whether you select Stainless Steel or Max•Steel, be assured that the same extraordinary quality of craftsmanship that has been our hallmark for more than 40 years, remains integral to every product that proudly bears the Omnia imprint. Stainless Steel or Max•Steel...the choice is yours. The quality, however, is ours alone.



TABLE OF CONTENTS

Section	Page
STAINLESS STEEL	3-7
Stainless Steel Latchsets Product Data	3
Stainless Steel Lever Latchsets.	4-5
Stainless Steel Product Data	6
Stainless Steel Metro Entrance Handleset . 7	
Stainless Steel Deadbolts.	7
Stainless Steel Privacy Bolt	7
Stainless Steel Trim.	7
MAX•STEEL	8-11
Max•Steel Latchsets Product Data	8
Max•Steel Lever & Knob Latchsets.	9
Max•Steel Mortise & Deadbolt Locksets . . .	10
Max•Steel Tudor Entrance Handleset. . . .	10
Max•Steel Locksets Product Data	11

FINISH OPTIONS

US32	Polished Stainless Steel
US32D	Stainless Steel
MAX•STEEL.	MAX•STEEL

CARE OF PRODUCT

Omnia's Stainless Steel requires minimal attention and will not tarnish or corrode under normal circumstances. However, exposure to certain chemical or environmental conditions may, over time, promote surface oxidation. Please be aware that this is not a defect in the stainless steel but a reaction on the surface of the finish to the chemical environment which can be removed with a stainless steel polish.

Stainless Steel Latchsets

- Will fit 2 1/8" bore.
- For commercial and residential use.
- 2 3/8" and 2 3/4" backsets available.
- Supplied for 2 3/8" backset and 1 3/8" door thickness unless otherwise specified.
- All lever latchsets are ADA approved.

Latch Features

- 28° retraction.
- 8 mm hub.
- Adjustable faceplate/armor plate for beveled doors.
- Built-in privacy feature with automatic release by inside lever or depression of latch nose.
- All dimensions are standard to fit existing bores for replacement installations.
- No. 013 "T" strike supplied as a standard or No.014 "Full Lip" strike as an option at no extra charge. No. 019 4 7/8" ASA strike also available. Specify when ordering. (See page 8 for diagram.)

Concealed Screw Roses:

Self-aligning, spring-assisted roses.

- 2 7/16" dia. x 1/2" proj. Shipped standard.
- 2" dia. x 7/16" proj. Optional. (To achieve a privacy function, a separate mortise privacy bolt must be ordered.)

Functions

Passage: Latch operates by lever from either side of door. Uses 8mm solid spindle.

Privacy: Latch operates by lever from either side. Push button on interior rose engages privacy; emergency release hole is on exterior rose. Turning inside lever will release privacy and retract latchbolt. For bathroom or bedroom. Uses 8mm split spindle.

Pair Dummy: Trim on both sides of door.

Single Dummy: Trim on one side of door only.

Passage Latches (8mm Hub)

107LPA38

2 3/8" backset
Passage Lever Latch

107LPA34

2 3/4" backset
Passage Lever Latch

Privacy Latches (8mm Hub)

108LPR38

2 3/8" backset
Privacy Lever Latch

108LPR34

2 3/4" backset
Privacy Lever Latch



All Omnia lever latchsets meet ADA accessibility requirements.

- A) Door knob/lever (2)
- B) Set Screws (2)
- C) Spindle (Teardrop groove positioned towards set screw)
- Da) Finished Rose
- Db) Plastic Sub-Rose
- E) Thru-bolt Screws (2)
- F) Privacy Locking Block
- G) Tubular Latch
- H) Tubular Latch Face Plate
- I) Tubular Latch Strike Plate
- J) Tubular Latch Dust Box
- Ka) Plastic Sub-Rose
- Kb) Finished Rose
- L) Privacy Locking Pin

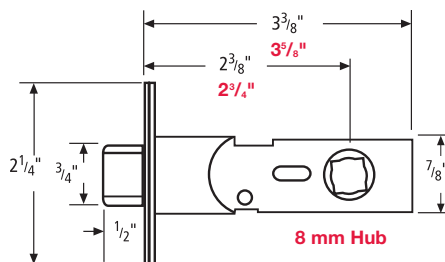

DRAWINGS NOT TO SCALE

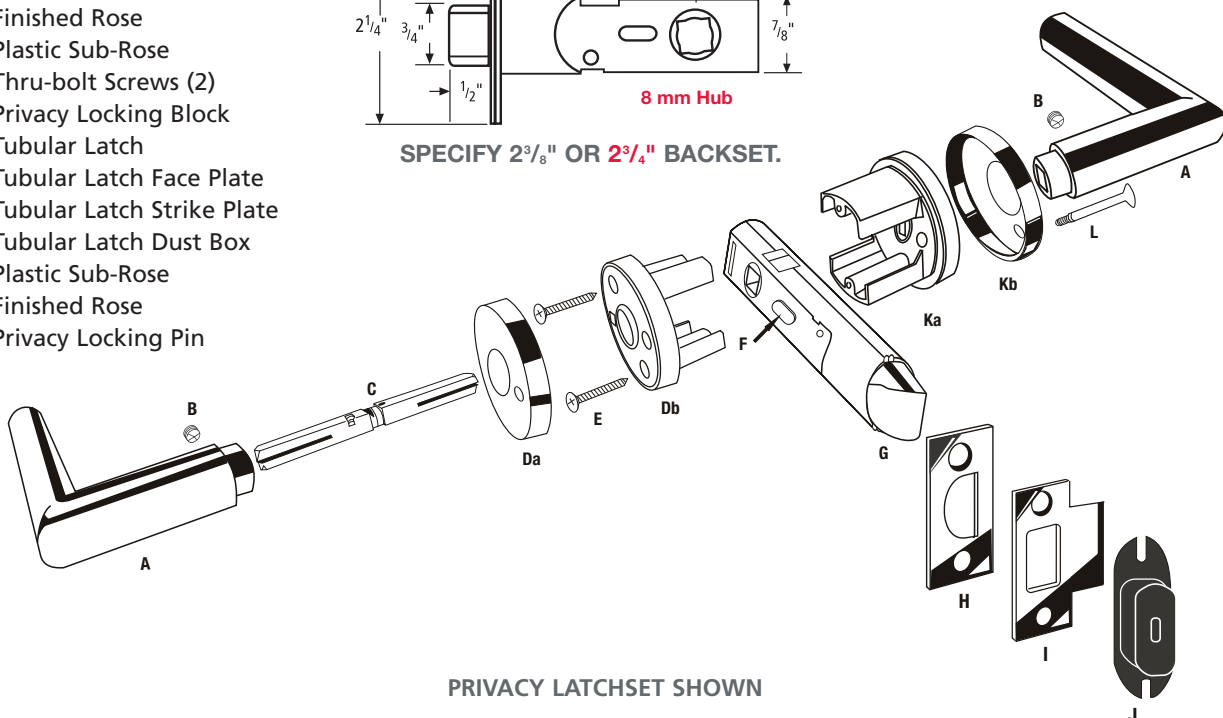

PRIVACY LATCHSET SHOWN

10

US32D

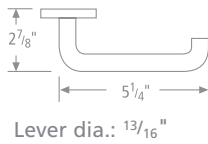

11

US32, US32D

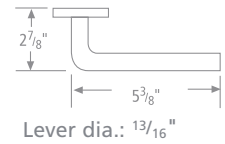

12

US32, US32D

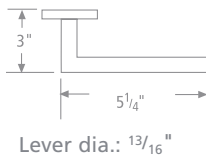

15

US32D

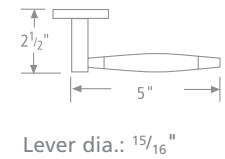

18

US32D

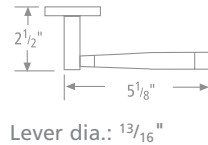

19

US32D

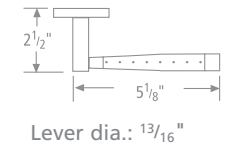

23

US32D

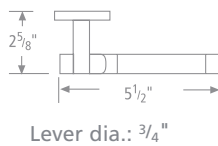

25

US32, US32D

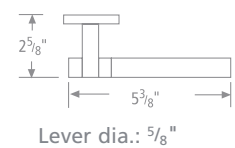

NOTE: All leversets also available with small rose as shown here.

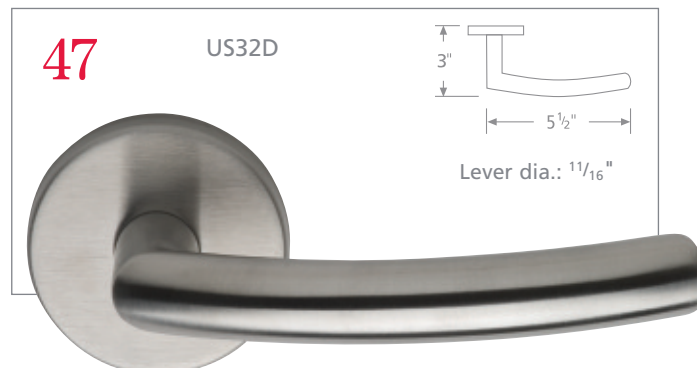
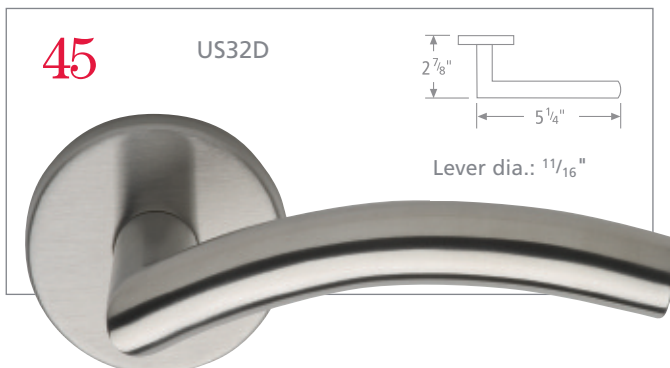
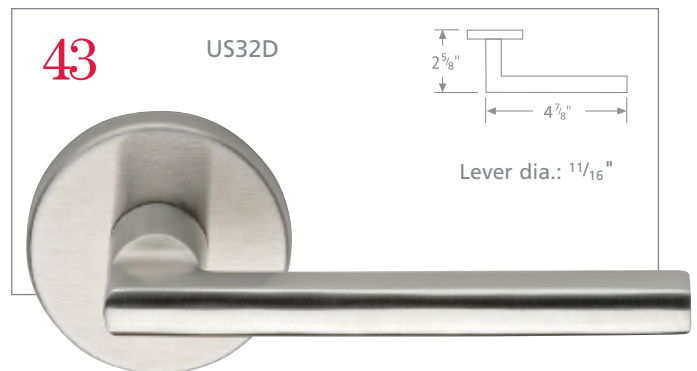
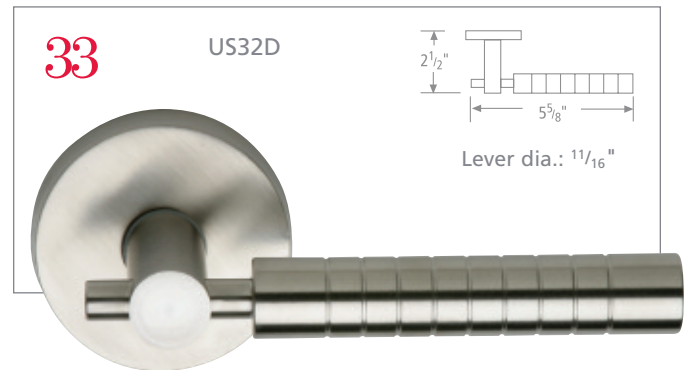
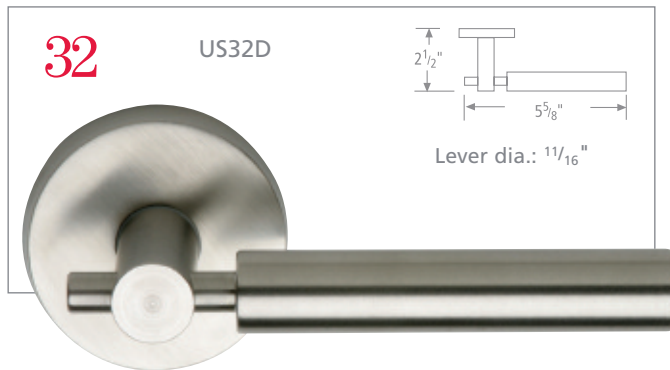
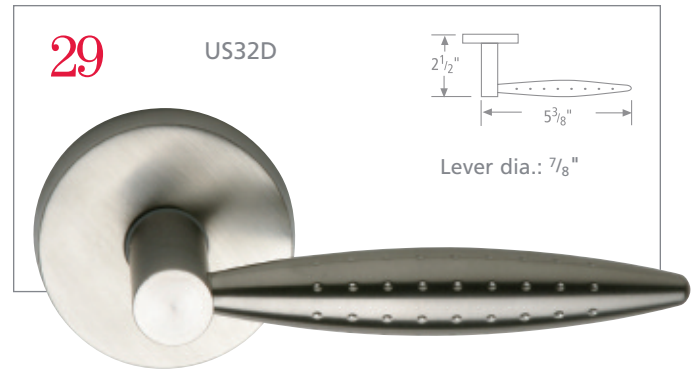



STAINLESS STEEL

Stainless Steel Metro Tubular Deadbolt Handleset

Available with two backset options – $2\frac{3}{8}"$ or $2\frac{3}{4}"$ ($2\frac{3}{8}"$ backset shipped standard). Please specify when ordering.

Lockset Options: **F, PD, SDE, SDI** (see box below)

Backplate Dimensions

$5\frac{1}{2}"$ center to center

Exterior (Top Plate) and Interior:

$10\frac{1}{4}" \times 2\frac{9}{16}" \times \frac{7}{16}"$

Exterior (Bottom Rose): $2\frac{1}{16}"$ diameter

Overall:

Exterior:

Length $16\frac{7}{8}" \times 3\frac{5}{16}"$ projection

Interior:

Length $10\frac{1}{4}" \times 2\frac{7}{8}"$ projection

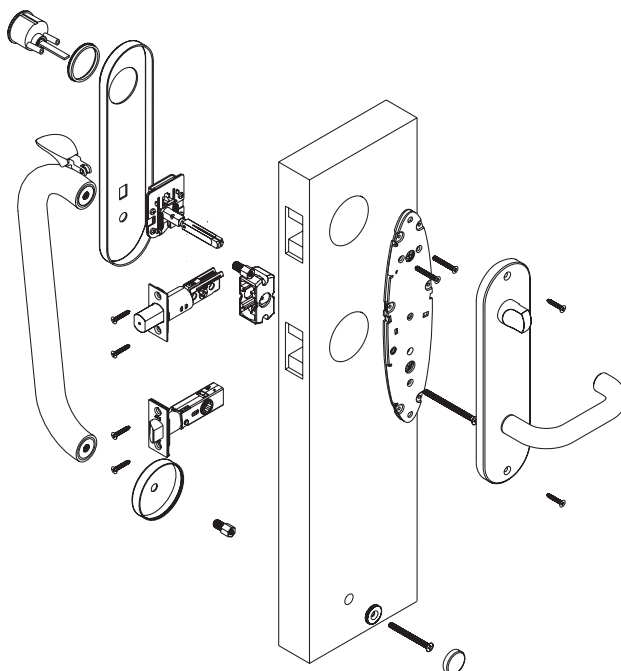

Stainless Steel Auxiliary Deadbolt Kits

Available in $2\frac{3}{8}"$ or $2\frac{3}{4}"$ backset. D9000 fits in $2\frac{1}{8}"$ standard bore. D9002 fits in $1\frac{3}{4}"$ standard bore.

Door Thickness: Both the D9000 and the D9002 are available for $1\frac{3}{8}"$ or $1\frac{3}{4}"$ thick doors.

Lock Options: **A and AC** (see box below)

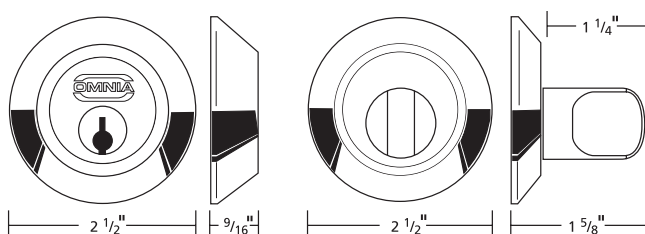

D9000

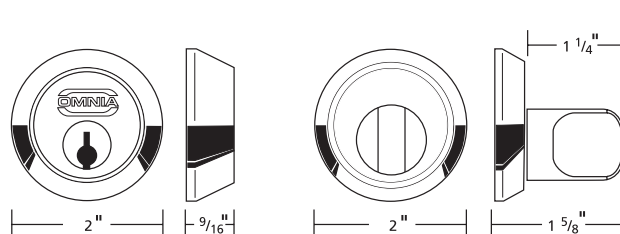

D9002

All Omnia cylinders are provided with a Schlage C keyway.

Stainless Steel Privacy Bolt

Available in $2\frac{3}{8}"$ or $2\frac{3}{4}"$ backset.

Faceplate: $2\frac{1}{4}" \times 1"$. Strike: $2\frac{3}{4}"$ dia. $\times 1\frac{1}{8}"$.

Inside & Outside Rose: $2"$ dia $\times \frac{3}{8}"$ depth.

Inside Turnpiece: $1\frac{1}{4}" \times 1\frac{3}{4}"$ proj. Bolt: $\frac{5}{8}"$.

Stainless Steel Floor Door Stop

7000 $1\frac{1}{8}"$ dia. $\times 1\frac{3}{4}"$ ht.

7001 $\frac{7}{8}"$ dia. $\times 1\frac{1}{4}"$ ht.

Ball Catch

Faceplate: $2\frac{1}{8}" \times 1\frac{1}{16}"$.

Barrel Diameter: $\frac{3}{4}" \times 1\frac{3}{8}"$ length.

Lock Options

Single Cylinder – **A**

Double Cylinder – **AC**

Panic Proof Entry – **F**

Pair Dummy – **PD**

Single Dummy Exterior – **SDE**

Single Dummy Interior – **SDI**

D9000 Stainless Steel
Auxiliary Deadbolt
US32D

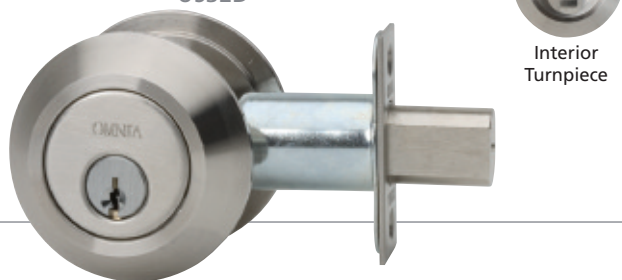

D9002 Stainless Steel
Auxiliary Deadbolt
US32D



6000 Privacy Bolt
US32D

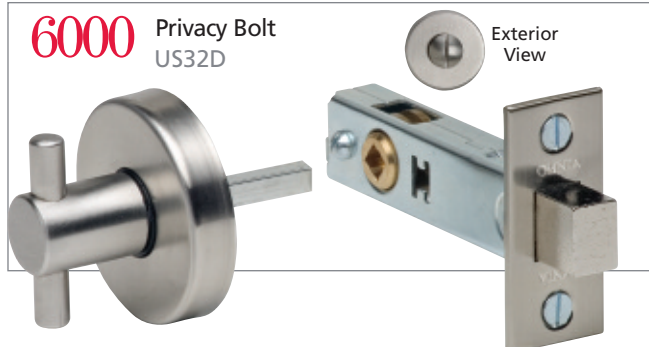

7000, 7001 Floor Door Stops
US32D



1600 Ball Catch
US15

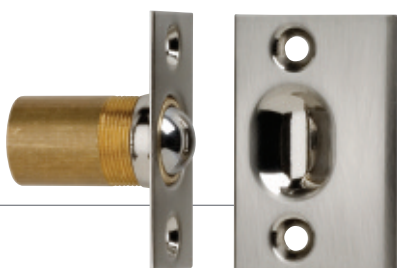

**Metro
Handleset**

Tubular Deadbolt
Lockset

5½" Center to Center

US32D



Metro
Interior Trim
With 12 Lever



Metro
Interior Trim
With 11 Lever

Max•Steel Latchsets

- Will fit 2 1/8" bore.
- For commercial and residential use.
- 2 3/8" and 2 3/4" backsets available.
- Supplied for 2 3/8" backset and 1 3/8" door thickness unless otherwise specified.
- All lever latchsets are ADA approved.

Latch Features

- 28° retraction.
- 7 mm hub.
- Adjustable faceplate/armor plate for beveled doors.
- Built-in privacy feature with automatic release by inside lever or depression of latch nose.
- All dimensions are standard to fit existing bores for replacement installations.
- Faceplates and strikes are solid brass. No. 013 "T" strike supplied as a standard or No.014 "Full Lip" strike as an option at no extra charge. No. 019 4 7/8" ASA strike also available. Specify when ordering.
- Critical interior parts are made of solid brass.

Concealed Screw Roses:

Thru-bolted roses

Modern	2 7/16" dia. x 1/2" proj.
Traditional	2 5/8" dia. x 1/2" proj.

Functions

Passage: Latch operates by knob or lever from either side of door. Uses 7mm solid spindle.

Privacy: Latch operates by knob or lever from either side. Push button on interior engages privacy; emergency release hole is on exterior rose. Turning inside lever will release privacy and retract latchbolt. For bathroom or bedroom. Uses 7mm split spindle.

Pair Dummy: Trim on both sides of door.

Single Dummy: Trim on one side of door only.

Passage Latches (7mm Hub)

105KPA38	2 3/8" backset Passage Knob Latch
105LPA38	2 3/8" backset Passage Lever Latch
105KPA34	2 3/4" backset Passage Knob Latch
105LPA34	2 3/4" backset Passage Lever Latch

Privacy Latches (7mm Hub)

106KPR38	2 3/8" backset Privacy Knob Latch
106LPR38	2 3/8" backset Privacy Lever Latch
106KPR34	2 3/4" backset Privacy Knob Latch
106LPR34	2 3/4" backset Privacy Lever Latch



All Omnia lever latchsets meet ADA accessibility requirements.

DRAWINGS NOT TO SCALE

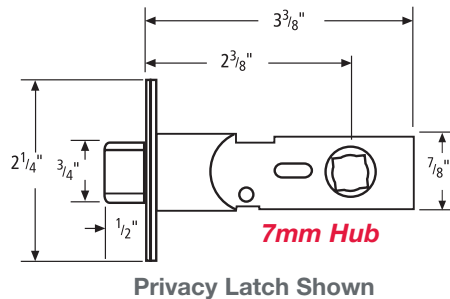
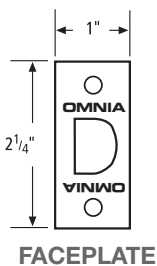

■ SPECIFY 2 3/8" OR 2 3/4" BACKSET. ■

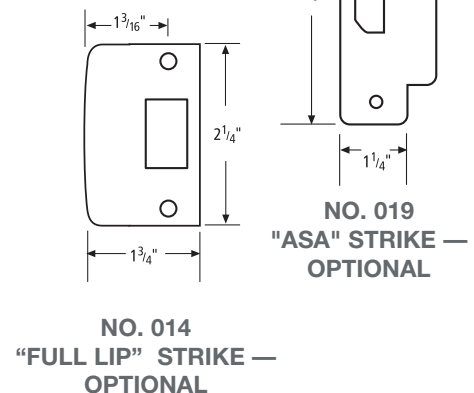
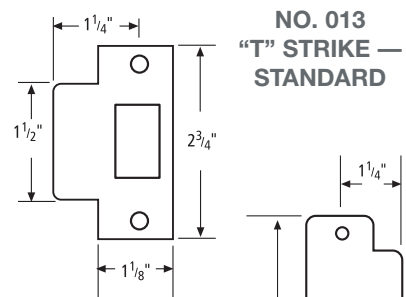
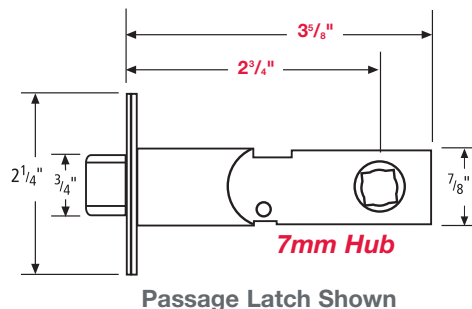

36

MAX•STEEL

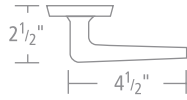

42

MAX•STEEL

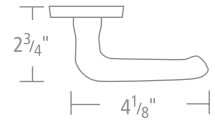

55

MAX•STEEL

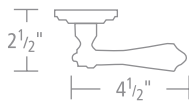

432

MAX•STEEL

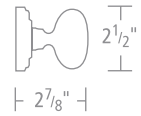

442

MAX•STEEL

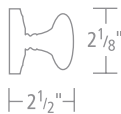

752

MAX•STEEL

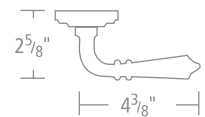

The MAX•STEEL Finish



11055 Mortise with Plates
1055 Mortise with Roses
D11055 Deadbolt with Plates
 10⁵/₈" Overall
 MAX•STEEL



11432 Mortise with Plates
1432 Mortise with Roses
D11432 Deadbolt with Plates
 10⁵/₈" Overall
 MAX•STEEL



11442 Mortise with Plates
1442 Mortise with Roses
D11442 Deadbolt with Plates
 10⁵/₈" Overall
 MAX•STEEL



11752 Mortise with Plates
1752 Mortise with Roses
D11752 Deadbolt with Plates
 10⁵/₈" Overall
 MAX•STEEL



12036 Mortise with Plates
2036 Mortise with Roses
D12036 Deadbolt with Plates
 10⁵/₁₆" Overall
 MAX•STEEL



12042 Mortise with Plates
2042 Mortise with Roses
D12042 Deadbolt with Plates
 10⁵/₁₆" Overall
 MAX•STEEL



D0806 Modern Auxiliary Deadbolt
 MAX•STEEL



D0806L Modern Low Profile Auxiliary Deadbolt
 MAX•STEEL



D0806T Traditional Auxiliary Deadbolt
 MAX•STEEL



Tudor

Mortise Entrance
 Handleset

16" Overall

MAX•STEEL



Tudor
 Interior Trim
 With 432 Knob



Tudor
 Interior Trim
 With 752 Lever

Max•Steel Tudor Mortise Entrance Handleset

With Thumbpiece and Handle Pull.

Available with two backset options — 2½" or 2¾". 2½" backset shipped standard. Please specify when ordering.

Lock Options: **A, AC, F, PD, SDE and SDI** (see box below)

Tudor Backplate Dimensions

Exterior (Top Plate) and Interior:
10⁵/₁₆" x 2³/₄" x 5¹/₁₆"

Exterior (Bottom Plate):
3¹/₁₆" x 1³/₄" x 5¹/₁₆"



Made In U.S.A.
Conforms to ANSI/BHMA
Series 1000 Standards

Max•Steel Mortise Locksets with Plates or Roses

Available with two backset options — 2½" or 2¾". Please specify when ordering.

Lock Options: **A, AC, F, EW, J, L, N, PD and SD** (see box below)

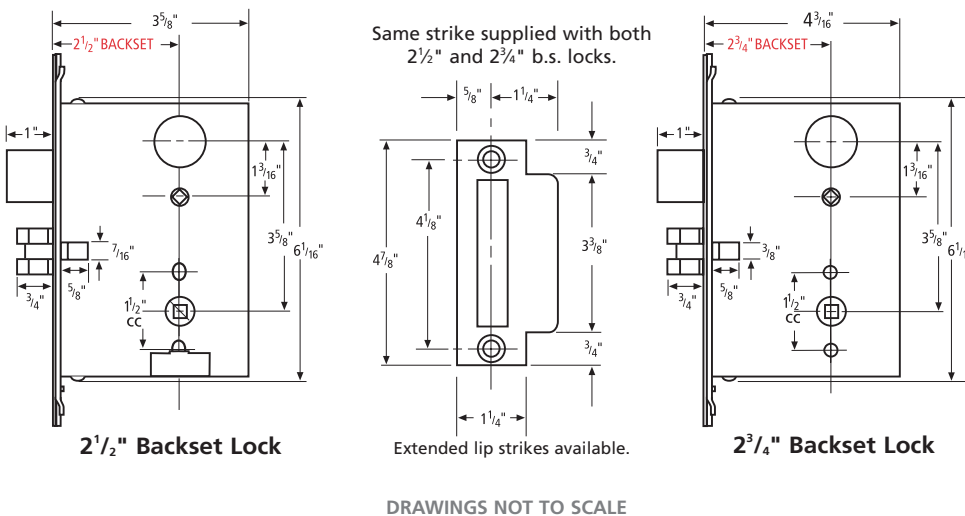

Made In U.S.A.
Conforms to ANSI/BHMA
Series 1000 Standards

Max•Steel Deadbolt Locksets with Plates

Available with two backset options — 2¾" or 2⅞". Please specify when ordering.

Lock Options: **A and AC** (see box below)

Max•Steel Auxiliary Deadbolt Kits

Available in 2¾" or 2⅞" backset. Fits in 2⅞" standard bore.

Lock Options: **A and AC** (see box below)

Max•Steel Mortise and Deadbolt Rose and Backplate Dimensions

1000 Series – Traditional Roses 2⁵/₈" dia. x 9¹/₁₆"

2000 Series – Modern Roses 2⁹/₁₆" dia. x 3³/₈"

11000 Series – Traditional Backplates 10⁵/₈" x 2³/₈" x 5¹/₁₆"

12000 Series – Modern Backplates 10⁹/₁₆" x 2³/₈" x 5¹/₁₆"

Lock Options

Single Cylinder – A	Classroom – J
Double Cylinder – AC	Privacy – L
Panic Proof Entry – F	Passage – N
Storeroom – EW	Pair Dummy – PD
Single Dummy Exterior – SDE	Single Dummy – SD
Single Dummy Interior – SDI	

■ Other Functions Available ■



All Omnia lever locksets meet
ADA accessibility requirements.





Stainless Steel also available in a full line of cabinet hardware and door pulls.



Box 330, Cedar Grove, NJ 07009 ■ www.OmniaIndustries.com ■ 973.239.7272 ■ Fax: 973.239.5960

© Copyright 2008, Omnia Industries, Inc.



No. SSMSC0708